

Vedic Cultural and Educational Center

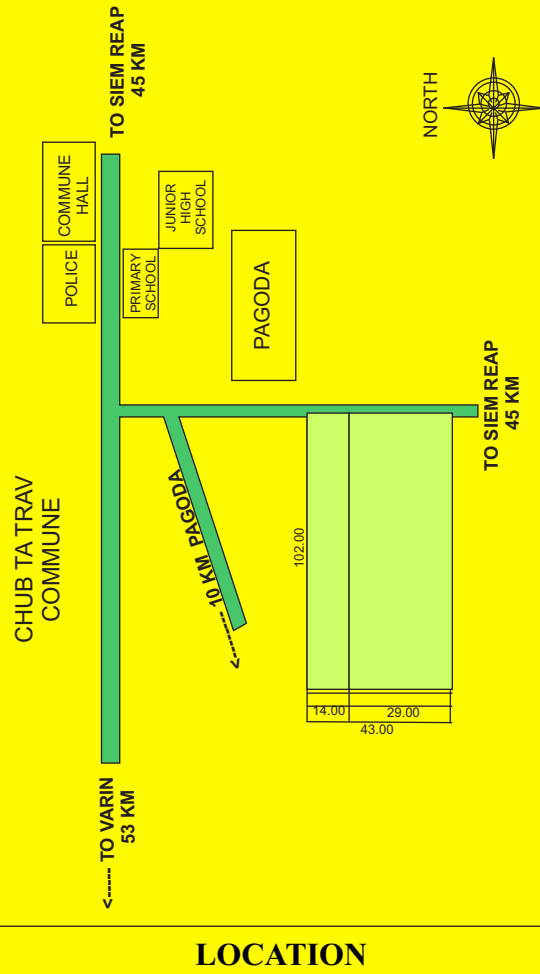

The sites are located at Chub and Prasat Village in the Province of Siem Reap not far from the famed Kulen Mountain, easily accessible by road approximately 35 kilometers from Angkor Wat. For more details visit our website at www.iskconcambodia.com

Yashodapura Eco Village Activities



Sadhu Sanga



Planting season



Go Puja on Purnima day

YASHODAPURA ECO VILLAGE

Vedic Cultural and Educational Center

MASTER PLAN

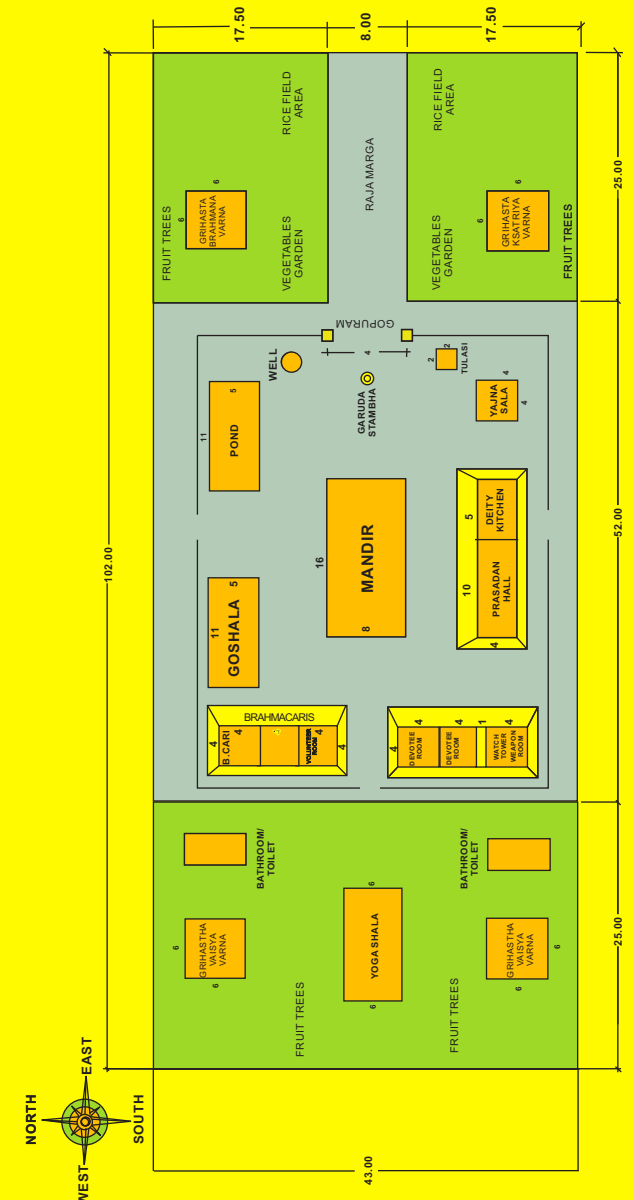



STAKEHOLDERS

Those who contribute more than USD1,000 will be invited to stay in our Guest House for one week per year for free.



ISKCON
iskconcambodhia.com

For details see Contacts listed below:

Kala Dasa(Canada) kala.dasa@gmail.com
Kisora Krishna Dasa(Indonesia) +62 852 38 4444 36
Guna Avatara (Cambodia) +855 11 368 114
Kumudaksa Dasa (Cambodia) +855 97 2801 649
Vishnurata Dasa (India) +91 98620 84531
Yadhava Hari Dasa (Indonesia) +62 812 7291 9643

YASHODAPURA ECO VILLAGE (YEV)

Vedic Cultural and Educational Center

*A Division of the International Society
for Krishna Consciousness(ISKCON)*



*Founder Acharya
His Divine Grace
A.C. Bhaktivedanta Swami
Srila Prabhupada*

MISSION & VISION

The YEV Vedic Cultural and Educational Center aims at providing opportunities to local Khmer villagers and visiting tourists to imbibe the ancient values and cultures of Cambodia and India through the medium of Yoga, Meditation, Natural Farming, Horticulture, Holistic Cow Care, Cottage Industries, Dioramas, Cultural Events, Tours and Educational Workshops.

OUR CULTURAL HERITAGE



BACKGROUND & HISTORY

The Kingdom of Cambodia is home for the famed 12th Century iconic architectural masterpiece ANGKOR WAT, the world's largest Vishnu temple that yearly attracts over 2.5 million tourists from across the globe. In addition to our ISKCON office in Siem Reap and our 108 acres Yashodapur Eco Village (YEV) near the sacred Mount Kulen, from year 2020 we are developing a Vedic Cultural Center on one acre of prime land close to YEV.

SALIENT FEATURES

The facilities will include a Goshala, Yoga Shala, Shrine, Guest House, Gardens, Fruit Orchards, Nursery, Admin Office, School, Library, Restaurant, Catering Service and Residential Quarters to be built in three phases within the next 3 years.